

NOTE: Zinc 3Cr. Plated and Black 3Cr. Plated are RoHS compliant trivalent finishes

CROSS RECESS PAN HEAD MACHINE SCREW JIS B1111 appendix

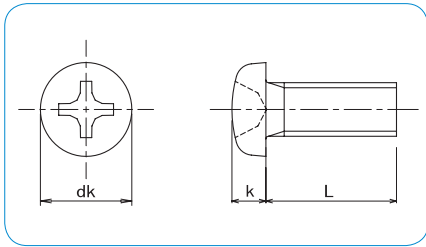

- **Material · plating**
Steel / Zinc 3Cr. Plated
Steel / Zinc Black 3Cr. Plated



How to order or inquire: R830-B1111PH-finish code diameter x length

Example: R830-B1111PH-CR3 3x10

Finish codes: CR3 for Zinc 3Cr. Plated, CR3B for Black 3Cr. Plated

	M2	M2.3	M2.5	M2.6	M3	M3.5	M4	M5	M6	M8	M10	
dk	3.5	4	4.5	4.5	5.5	6	7	9	10.5	14	19	
k	1.3	1.5	1.7	1.7	2	2.3	2.6	3.3	3.9	5.2	6	
Drive Size	1				2				3		4	

pcs / Box											
L \ d	M2	M2.3	M2.5	M2.6	M3	M3.5	M4	M5	M6	M8	M10
3	12,000	8,000	5,000	5,000	3,000		2,800				
4	10,000	7,000	5,000	5,000	3,000	4,000	2,500	1,000			
5	8,000	6,000	5,000	5,000	3,000	4,000	2,500	1,000			
6	8,000	6,000	4,500	4,500	2,500	3,500	2,200	1,000	600		
8	6,000	5,000	3,500	3,500	2,200	2,500	2,000	1,000	600	350	
10	5,000	4,000	3,000	3,000	2,000	2,500	1,600	900	600	300	
12	4,000	2,500	2,500	2,500	2,500	2,000	1,500	800	600	300	
14	3,000	2,200	2,000	2,000	2,200	1,600	1,200	800	500	250	
15	3,000	2,200	1,800	2,000	2,000	1,600	1,200	700	500	250	
16	2,500	2,200	1,800	1,800	2,000	1,600	1,000	700	450	250	200
18	2,200	2,000	1,500	1,500	1,600	1,200	1,000	600	400	200	
20	2,000	1,500	1,500	1,500	1,500	1,200	900	500	350	200	180
22	1,500			1,000	1,400	1,000	800	700		250	
25	1,500	1,000	1,000	1,000	1,200	1,000	700	700	500	220	150
30	1,000	800	800	800	1,000	800	600	600	400	200	130
35	1,000		500	500	700	600	500	500	300	180	120
40	700		500	500	600	800	600	400	300	160	100
45			500	500	800	600	500	350	250	150	80
50			500	500	600	500	450	300	200	130	80
55					600		400	250	200	120	80
60				* 500	500		300	230	180	100	70
65					500		300	200	150	100	70
70					800		300	200	120	90	60
75					700		300	200	200	90	60
80					* 500		300	200	200	90	50
85					* 500		300	300	180	* 80	50
90					* 500		400	250	170	80	50
95					* 400		400	250	170	* 80	50
100					* 400		400	250	150	80	50
105					* 500		* 400	* 250	150	* 80	
110					* 500		* 350	* 220	150	* 80	
115					* 500		* 350	* 200	130	* 80	
120					* 500		* 350	* 200	130	* 80	
125					* 500		* 350	* 200	120	* 80	
130					* 600		* 350	* 200	120	* 80	
135					* 600		* 350	* 200	150	* 80	
140					* 600		* 350	* 200	150	* 80	
145					* 600		* 350	* 200	150	* 80	
150					* 600		* 350	* 200	150	* 80	
160					* 600		* 300	* 200	* 150		
170					* 600		* 300	* 200	* 150		
180					* 600		* 300	* 200	* 150		
190					* 600		* 300	* 200	* 150		
200					* 600		* 300	* 200	* 150		

* ... Zinc 3Cr. Plated only

CROSS RECESS PAN HEAD MACHINE SCREW JIS B1111 appendix

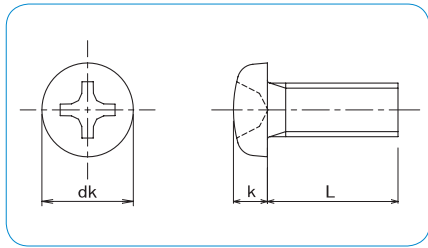

●Material
Stainless Steel A2



How to order or inquire: R830-B1111PH-material code diameter x length

Example: R830-B1111PH-A2 4x16

Material codes: A2 for Stainless Steel A2

	M2	M2.3	M2.5	M2.6	M3	M4	M5	M6	M8	M10
dk	3.5	4	4.5	4.5	5.5	7	9	10.5	14	19
k	1.3	1.5	1.7	1.7	2	2.6	3.3	3.9	5.2	6
Drive Size	1				2			3		4

		pcs / Box									
d	L	M2	M2.3	M2.5	M2.6	M3	M4	M5	M6	M8	M10
3	3	10,000	10,000	8,000	8,000	4,000					
4	4	10,000	10,000	8,000	8,000	2,000	2,000				
5	5	10,000	6,000	6,000	6,000	2,000	1,000				
6	6	10,000	8,000	6,000	6,000	2,000	1,000	1,000	500		
8	8	8,000	6,000	5,000	4,000	2,000	1,000	1,000	500		
10	10	6,000	6,000	4,000	4,000	2,000	1,000	500	500	200	
12	12	6,000	4,000	3,000	3,000	2,000	1,000	500	500	200	
14	14	4,000	4,000	3,000	3,000	2,000	1,000	500	500	200	
15	15	4,000	3,000	2,500	2,000	1,000	1,000	500	500	200	
16	16	4,000		2,000	2,000	1,000	1,000	500	200	100	100
18	18	3,000			2,000	1,000	500	500	200	100	
20	20	3,000	2,000	2,000	2,000	1,000	500	500	200	100	100
22	22						500	500	200		
25	25	2,000	1,000	1,500	1,000	1,000	500	400	200	100	50
30	30	1,000	1,000	1,000	1,000	500	500	200	200	100	50
35	35					500	500	200	200	100	50
40	40					500	200	200	100	50	50
45	45					500	200	200	100	50	50
50	50					500	200	100	100	50	50
55	55						200	100	100	50	50
60	60						200	100	100	50	50
65	65						200	100	100	50	50
70	70						200	100	100	50	50
75	75						200	100	100	50	50
80	80						200	100	100	50	50
90	90						200	100	50	50	50
100	100						200	100	50	50	50

SUS 316L

TITAN

CROSS RECESS PAN HEAD MACHINE SCREW JIS B1111 appendix

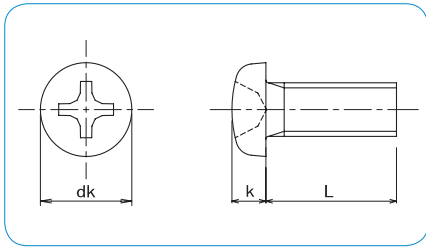

RoHS Directive Compliance

	M3	M4	M5	M6	M8
dk	5.5	7	9	10.5	14
k	2	2.6	3.3	3.9	5.2
Drive Size	2			3	

How to order or inquire: R830-B1111PH-material code diameter x length
 Example: R830-B1111PH-316L 4x16
 Material codes: 316L for Stainless Steel 316L

How to order or inquire: R830-B1111PH-material code diameter x length
 Example: R830-B1111PH-TI 4x16
 Material codes: TI for Titanium



● **Material**

SUS 316L Stainless Steel A4

pcs / Box

L \ d	M3	M4	M5	M6	M8
5	500				
6	500	300	200		
8	500	300	200		
10	500	300	200	100	
12	500	300	200	100	50
15	500	300	200	100	50
16	500	300	200	100	50
20	500	300	200	100	50
25	500	300	200	100	50
30	500	300	200	100	50
35		300	200	100	50
40	500	300	200	100	50
45		300	200	100	50
50		300	200	100	50
55		300	200	100	50
60		300	200	100	50
65		300	200	100	50
70			200	100	50
75			200	100	50
80				100	50
90				100	50
100				100	50



● **Material**

TITAN

pcs / Box

L \ d	M3	M4	M5	M6
6	500	300		
8	500	300	200	
10	500	300	200	100
12	500	300	200	100
15	500	300	200	100
16	500	300	200	100
20	500	300	200	100
25	500	300	200	100
30	500	300	200	100
35		300	200	100
40		300	200	100
45			200	100
50			200	100
60				100