

NOTE: Zinc 3Cr. Plated and Black 3Cr. Plated are RoHS compliant trivalent finishes

## HEX SOCKET CAP SCREW WITH FLANGE

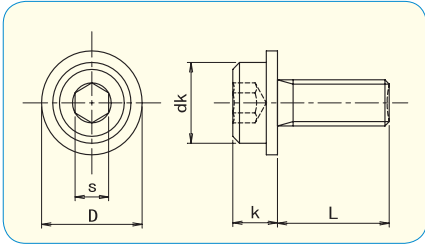

How to order or inquire: R830-SCF-finish code diameter x length

Example: R830-SCF-CR3 4x10

Finish codes: CR3 for Zinc 3Cr. Plated, CR3B for Black 3Cr. Plated

	M3	M4	M5	M6	M8	M10	M12
dk	5.5	7	8.5	10	13	16	18
k	3	4	5	6	8	10	12
s	2.5	3	4	5	6	8	10
D	7.5	9	11	12.5	17	21	24



**Material - plating**

Steel 10.9 / Zinc 3Cr. Plated

Steel 10.9 / Zinc Black 3Cr. Plated

		pcs / Box					
L \ d	M3	M4	M5	M6	M8	M10	M12
5	1000						
6	1000	1000					
8	1000	1000	500	500			
10	1000	1000	500	400			
12	1000	1000	500	400	200		
14		1000		400			
15		1000	500	400	200	100	
16	1000	1000	500	400	200	100	
18		1000	500	400	200		
20	1000	1000	400	400	200	100	
25		500	400	300	200	100	80
30		500	300	300	100	100	70

How to order or inquire: R830-SCF-material code diameter x length

Example: R830-SCF-A2 4x16

Material codes: A2 for Stainless Steel A2

**Material**

Stainless Steel A2

		pcs / Box			
L \ d	M4	M5	M6	M8	
6	100	100			
8	100	100	100		
10	100	100	100	100	
12	100	100	100	100	
15	100	100	100	100	
16	100	100	100	100	
20	100	100	100	100	
25		100	100	100	
30				100	

NOTE: Zinc 3Cr. Plated and Black 3Cr. Plated are RoHS compliant trivalent finishes

# HEX SOCKET BUTTON HEAD SCREW WITH FLANGE

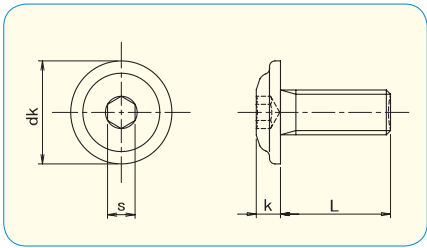

How to order or inquire: R830-BSCF-finish code diameter x length

Example: R830-BSCF-CR3 4x10

Finish codes: CR3 for Zinc 3Cr. Plated, CR3B for Black 3Cr. Plated



RoHS Directive Compliance

	M3	M4	M5	M6	M8	M10
dk	7	9.2	11.4	13.6	17	20.9
k	1.65	2.2	2.75	3.3	4.4	5.5
s	2	2.5	3	4	5	6

● **Material - plating**

Steel 10.9 / Zinc 3Cr. Plated

Steel 10.9 / Zinc Black 3Cr. Plated

pcs / Box

L \ d	M3	M4	M5	M6	M8	M10
6	1,000	1,000				
8	1,000	1,000	1,000	500		
10	1,000	1,000	1,000	500	200	
12	1,000	1,000	1,000	500	200	
15	1,000	1,000	500	500	200	
16	1,000	1,000	500	500	200	200
20	1,000	1,000	500	500	200	200
25		1,000	500	500	200	100
30			500	500	200	100

How to order or inquire: R830-BSCF-material code diameter x length

Example: R830-BSCF-A2 4x16

Material codes: A2 for Stainless Steel A2

● **Material**

Stainless Steel A2

pcs / Box

L \ d	M3	M4	M5	M6
6	1,000	200		
8	1,000	200	200	50
10		200	200	50
12		200	200	50
15		200	200	50
16		200	200	50
20		200	200	50
25		200	200	50
30				50