

Circular External Nuts

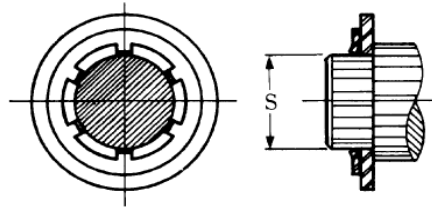

Applicator

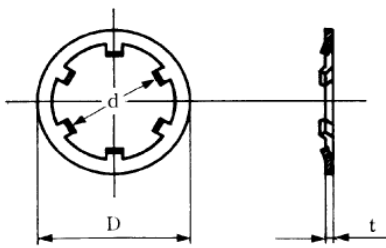
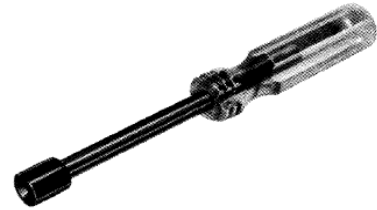

Unit : mm

Size-No.	Ring dimension					Nos. of Teeth	Applicable shaft		Thrust Load N
	d		D		t		S		
	Basic	Tol.	Basic	Tol.			Basic	Tol.	
CSTW- 2	1.9	±0.05	6	±0.2	0.25	3	2	+0.03	58.84
2.4	2.2	+0.1	6.4		0.25	3	2.4	±0.03	58.84
3	2.8	0	8		0.25	4	3		88.26
3.5	3.3	-0.1	7.5		0.25	4	3.5		98.07
4	3.8	+0.1	9		0.25	4	4		117.68
4.5	4.3	0	10		0.25	5	4.5		137.30
5	4.8		10		0.25	5	5		156.91
6	5.8		11		0.25	5	6		176.52
8	7.8		13		0.25	5	8		205.94
10	9.8		15.4		0.25	6	10		205.94
12	11.8		17.8	±0.3	0.4	6	12		225.56
14	13.8		20.3		0.4	6	14	±0.05	225.56
16	15.8		22.8		0.4	6	16		225.56
18	17.8		25		0.4	8	18		245.17
19	18.7	±0.15	25.4		0.4	6	19		245.17
20	19.8	+0.1	28		0.4	8	20		245.17

●Material=Carbon spring steel. Hardness=HRC40~50. Finish=Phosphate coating.

●Material=Stainless spring steel ; SUS304, precipitation hardening stainless steels.

Note; 1. The data of thrust load shows the value when the nut is tested by the shaft made of cold rolled steel.

2. This ring can not use of hardened shaft.

Circular Internal Nuts

Installed

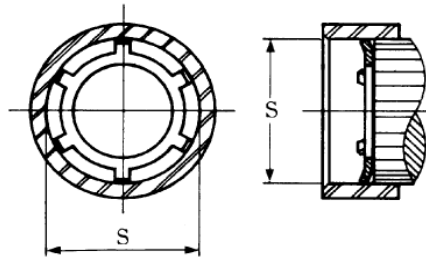
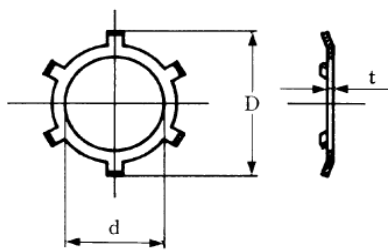

Applicator

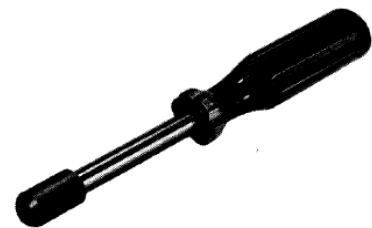

Unit : mm

Size-No.	Ring dimension					Nos. of Teeth	Applicable bore		Thrust Load N
	D		d		t		S		
	Basic	Tol.	Basic	Tol.			Basic	Tol.	
CRTW- 6	6.2	0	2.2	±0.2	0.25	6	6	±0.03	196.14
8	8.2	-0.1	3.6		0.25	6	8		196.14
10	10.2		5		0.25	6	10		176.52
12	12.2		6.6		0.25	6	12		147.10
14	14.2		8.2		0.25	6	14		127.49
16	16.2		9.8		0.25	6	16		117.68
18	18.2		11		0.4	8	18		294.20

●Material=Stainless spring steel ; SUS304, precipitation hardening stainless steels.

Note; 1. The data of thrust load shows the value when the nut is tested by the bore made of cold rolled steel.

2. This ring can not use of hardened bore.