

**RAMPA Cross Dowels type 2Q**  
can be employed in the same way as RAMPA Cross Dowels type Q (p. 20). They have one slot and two threads across the dowel.

**RAMPA Dowel Nuts type RSK** with hexagonal socket are used in the assembly of tubular steel furniture, which can be disassembled. The nut lies crosswise in the tube and the internal thread tightens a through-bolt.

**RAMPA Knurled Nuts type RM** used as plugs, are knocked and glued into pre-drilled holes.

Maryland Metrics  
<http://mdmetric.com>

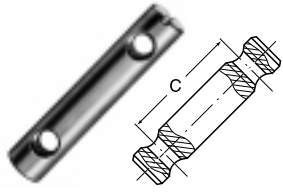

RAMPA Cross Dowels type 2Q

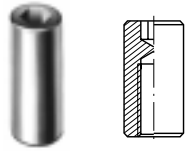

RAMPA Dowel Nuts type RSK

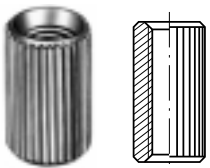

RAMPA Knurled Nuts type RM

XXX = available from stock

Type 2Q Article No.	External Ø	Length	Internal Thread	Distance C	Kilos per 1000	Steel zinc plated
020 201 001	10	48	M 6	32	24,8	XXX
020 982 001	10	82	M 6	64	42,4	XXX
020 970 001	12	70	M 8	52	53,5	XXX

Type RSK Article No.	External Ø	Length	Internal Thread	Internal Hex Socket	Kilos per 1000	Steel	
						plain	zinc plated <sup>1)</sup>
027 616 ...	10	16	M 6	SW 5	6,9	XXX	XXX
027 618 ...	10	18	M 6	SW 5	7,7	XXX	XXX
027 620 ...	10	20	M 6	SW 5	8,4	XXX	XXX
027 630 ...	10	30	M 6	SW 5	13,0	XXX	XXX
027 723 ...	12	23	M 6	SW 5	16,1	XXX	XXX
027 726 ...	12	26	M 6	SW 5	18,2	XXX	XXX
027 730 ...	12	30	M 6	SW 5	21,0	XXX	XXX
027 736 ...	12	36	M 6	SW 5	25,2	XXX	XXX

Please complete in order  
<sup>1)</sup>001 for steel zinc plated

Type RM Article No.	External Ø	Length	Internal Thread	Knurting	Kilos per 1000	Steel	
						plain	zinc plated <sup>1)</sup>
024 615 ...	10	15	M 6	1,0	6,5	XXX	XXX
024 616 ...	10	16	M 6	1,0	6,9	XXX	XXX
024 618 ...	10	18	M 6	1,0	7,7	XXX	XXX
024 621 ...	10	21	M 6	1,0	8,6	XXX	XXX
024 628 ...	10	28	M 6	1,0	11,5	XXX	XXX
024 635 ...	10	35	M 6	1,0	14,5	XXX	XXX
024 640 ...*	10	40	M 6	1,0	17,2	XXX	XXX
024 645 ...*	10	45	M 6	1,0	19,3	XXX	XXX

Please complete in order  
<sup>1)</sup>001 for steel zinc plated

\*threaded blind-hole on both ends